

**FICHE D'OMOLOGATION
HOMOLOGATION FORM**



Motori Seven

Via Perticara 130
47023 Cesena (FC)
ITALY

Costruttore	Manufacturer	Motori Seven
Marca	Make	Motori Seven
Modello	Model	L6 A 70/85 cc
Tipo di ammissione	Inlet type	Reed Valve
Numero di pagine	Number of pages	7



FOTO DEL MOTORE
DRAWING OF ENGINE

Firma e Timbro
Signature and stamp

MOTORI SEVEN
di BENEDETTI OSCAR
Via Perticara, 130
47023 CESENA - FC
Part. IVA 03110790403

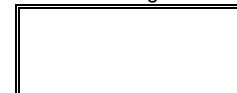

INFORMAZIONI TECNICHE		TECHNICAL INFORMATION	
A	CARATTERISTICHE	A	CHARACTERISTICS
			Tolérances
	Volume del cilindro	<i>Volume of cylinder</i>	79,81
	Alesaggio d'origine	<i>Original Bore</i>	47,00
	Alesaggio teorico massimo	<i>Theoretical maximum bore</i>	48,50
	Corsa	<i>Stroke</i>	46,00
	Sistema di raffreddamento	<i>Cooling system</i>	WATER COOLED
	Numero carburatori	<i>Number of carburation systems</i>	1
	Numero dei canali di travaso	<i>Number of transfer ducts, cylinder/sump</i>	5
	Numero luci di scarico	<i>Number of exhaust ports / ducts</i>	3
	Forma della camera di combustione	<i>Shape of the combustion chamber</i>	SPHERICAL-WITH SQUISH
	Materiali della parete del cilindro	<i>Cylinder wall material</i>	ALL.NIKASIL
	Interasse biella	<i>Length between the axes of the connecting rod</i>	100 ±0.1mm
	Numero segmenti pistone	<i>Number of piston rings</i>	1 o 2

B	ANGOLO DI APERTURA SCARICO	B	OPENING ANGLES
	Dello scarico	<i>Exhaust</i>	199° Max

C	MATERIALI	C	MATERIAL
	Cilindro	<i>Cylinder</i>	AL-SI
	Testa	<i>Cylinder head</i>	AL-SI-CU
	Carter	<i>Sump</i>	AL-SI
	Biella	<i>Connecting rod</i>	STEEL NICRMO



DISEGNO DELLO SVILUPPO DEL CILINDRO

DRAWING OF THE CYLINDER DEVELOPMENT

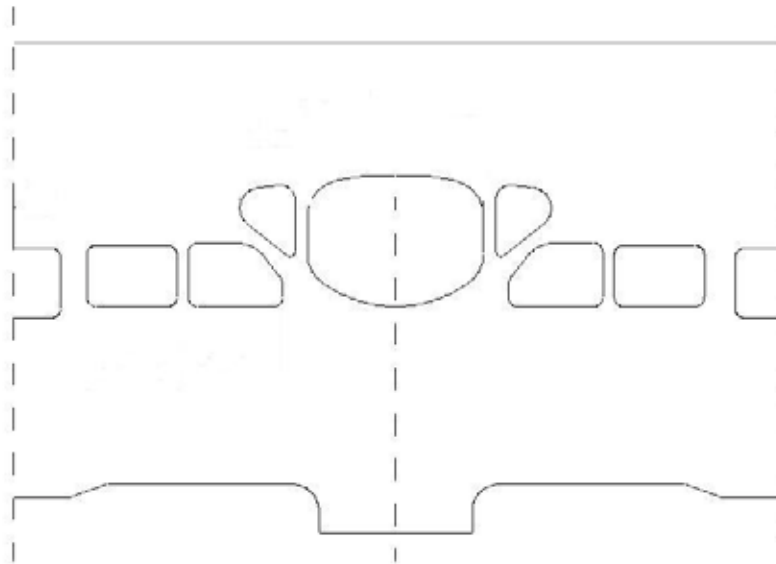
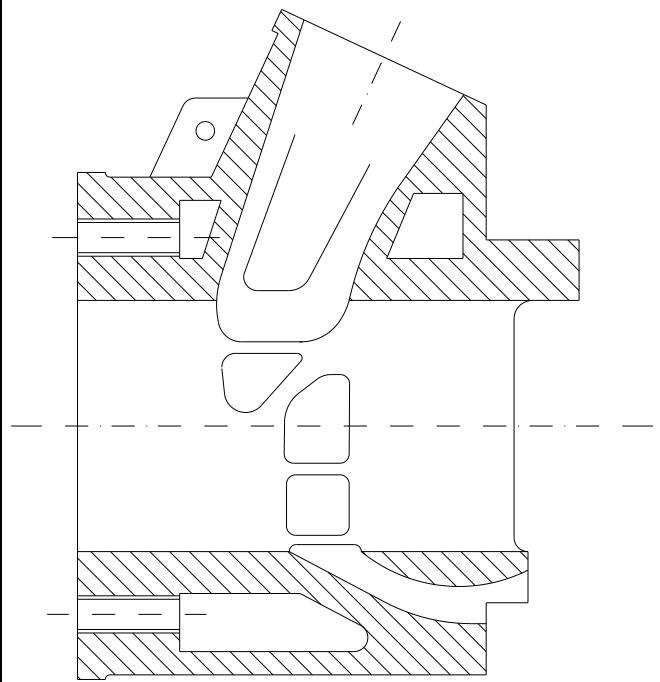
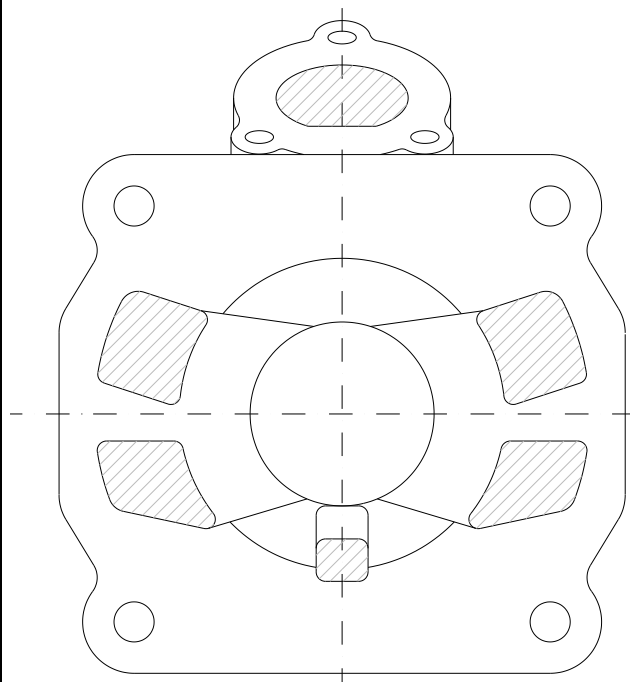



DISEGNO DELLA
BASE DEL CILINDRODRAWING OF THE
CYLINDER BASEVISTA SEZIONE DEL
CILINDROSECTION VIEW OF
CYLINDER

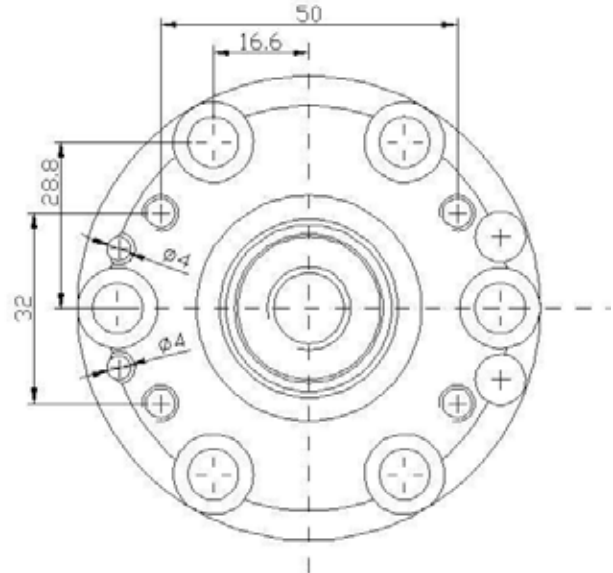
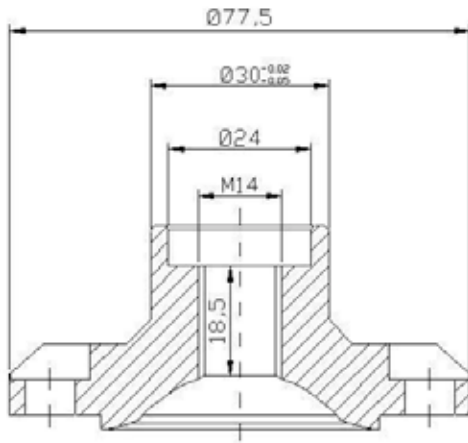
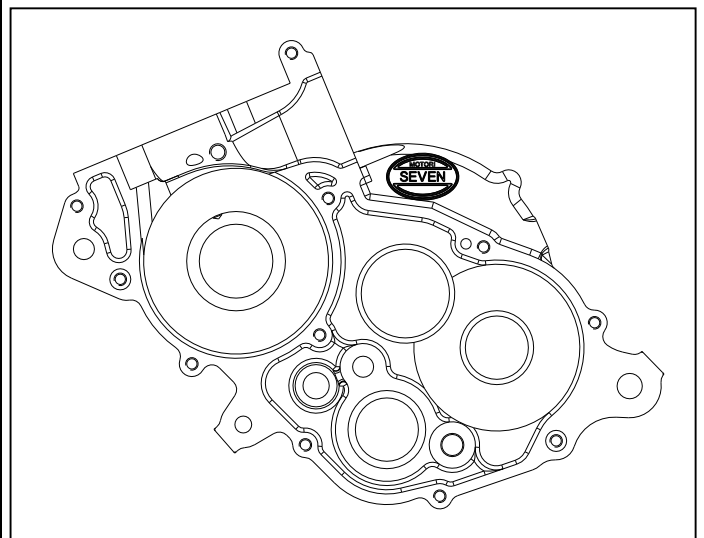
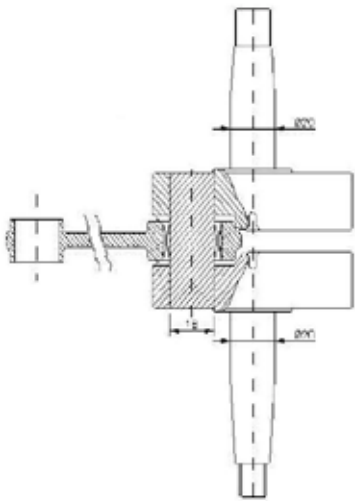





DISEGNO DELLA CAMERA DI COMBUSTIONE

DRAWING OF THE CYLINDER HEAD AND OF
THE COMBUSTION CHAMBERDISEGNO ALBERO
MOTOREDISEGNO INTERNO
CARTERDRAWING OF THE
INSIDE OF SUMP

--

FOTO DEL DIETRO DEL MOTORE	<i>PHOTO OF THE BACK OF THE ENGINE</i>	FOTO DEL DAVANTI DEL MOTORE	<i>PHOTO OF THE FRONT OF ENGINE</i>
			
FOTO DEL MOTORE PARTE SUPERIORE	<i>PHOTO OF THE ENGINE TAKEN FROM ABOVE</i>	FOTO DEL MOTORE PARTE INFERIORE	<i>PHOTO OF THE ENGINE TAKEN FROM BELOW</i>
			

--

FOTO DEL PIEDE DEL CILINDRO	PHOTO OF THE BASE OF THE CYLINDER	FOTO DELLA CAMERA DI COMBUSTIONE	PHOTO OF COMBUSTION CHAMBER
			
FOTO CARTER (VISTA TRE QUARTI)	PHOTO OF THE SUMP (GASKET FACE)	FOTO DI UNA PARTE INTERNA DEL CARTER	PHOTO OF AN INTERNAL PART OF THE SUMP
			

Homologation N°

FOTO MOTO LATO SINISTRO

PHOTO OF MOTOBIKE LEFT SIDE



